

Plot Date: 6/12/2015 3:59 PM

M:\ARCH\STANTON CITY HALL\CIVIL\STANTON CITY HALL CIVIL PLANS-1-05-2015-2000.DWG



### GENERAL NOTES

LOCATE PROPERTY LINES, RIGHTS-OF-WAY AND UNDERGROUND UTILITIES AND PROTECT UNDERGROUND UTILITIES.

NOTIFY ENGINEER OF ANY AREAS WHERE UNACCEPTABLE SOILS, SINKHOLES, WET AREAS OR OTHER CONDITIONS ARE ENCOUNTERED WHICH MAY ADVERSELY AFFECT THE SITE. IF DIRECTED BY ENGINEER, REMOVE UNSUITABLE SOILS AND REPLACE THEM WITH ACCEPTABLE SOILS.

EARTH AND ROCK WORK IS UNCLASSIFIED. NO EXTRA PAYMENT WILL BE MADE FOR ROCK EXCAVATION.

MAKE MINOR ADJUSTMENTS IN GRADING PLAN AS NECESSARY TO PROVIDE FOR SMOOTH TRANSITION FOR EXISTING ENTRANCES.

ESTABLISH EROSION CONTROL MEASURES BEFORE DISTURBING SITE.

MINIMIZE TRACKING OF MUD ONTO PAVED ROADWAY FROM CONSTRUCTION AREAS. THE CONTRACTOR SHALL DAILY REMOVE MUD/SOIL FROM PAVEMENT, AS MAY BE REQUIRED.

PROVIDE TRAFFIC CONTROL IN ACCORDANCE WITH THE MANUAL FOR UNIFORM TRAFFIC CONTROL DEVICES AND THE KENTUCKY DEPARTMENT OF HIGHWAYS GUIDANCE MANUAL.

MAINTAIN ACCESS TO EXISTING BUSINESSES AND EXISTING ROADS.

ALL EARTHWORK TO COMPLY WITH RECOMMENDATIONS OF GEOTECHNICAL REPORT.

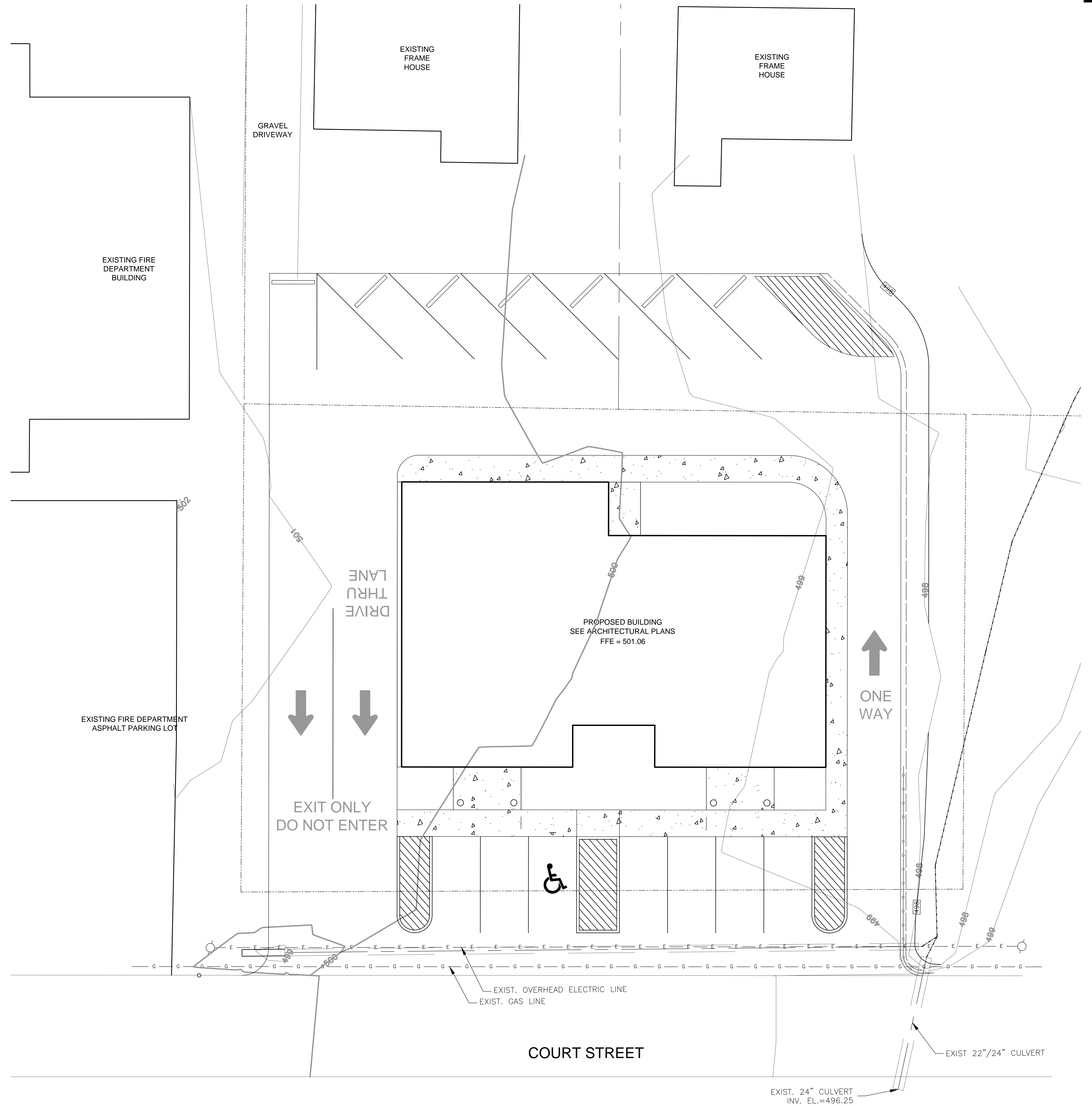

LOCATION SITE PLAN  
SCALE: 1" = 10'

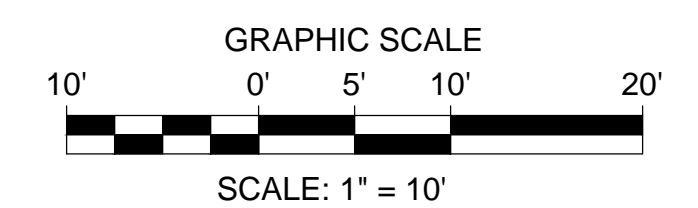

| PROJECT NO.          | DATE | REVISION |
|----------------------|------|----------|
| 4065-09              |      |          |
| DESIGNED BY: E.G.M.  |      |          |
| DRAWN BY: J.D.W.     |      |          |
| CHECKED BY: E.G.M.   |      |          |
| REVIEWED BY: E.G.M.  |      |          |
| DATE: DECEMBER, 2014 |      |          |
| SCALE: AS SHOWN      |      |          |

Engineers  
Architects  
Planners

**nse**  
OF KENTUCKY, INC.

624 Wellington Way  
Lexington, Ky. 40503  
Phone: (859)223-5694  
Fax: (859)223-2607  
www.nselex.com

LOCATION SITE PLAN  
CITY OF STANTON  
CITY HALL & POLICE STATION  
STANTON, KENTUCKY

DRAWING NO. 1  
SHEET OF